



BRYTHILL DRIVE, Brierley Hill, DY5 3LU

Offers In Region Of £269,950

3 2 1

- A BEAUTIFULLY PRESENTED THREE BEDROOM, THREE STOREY SEMI DETACHED FAMILY HOME as a canal side setting and is within close proximity to local amenities.
- Modern Kitchen, spacious Living Room, downstairs Cloakroom.
- The Master Bedroom is found to the Second Floor having a Dressing Area and a spacious Ensuite to the side.
- Offering easy to move in living accommodation, an early view is recommended.
- Pleasantly located within 'Lockside Walk'. Built in 2015 by Taylor Wimpey.
- This impressive semi-detached family home provides versatile living accommodation to include a Kitchen, spacious Living Room, downstairs Cloakroom, two Bedrooms and a Family Bathroom to the first floor (the second bedroom is currently used as a Living Room) with the Master Bedroom found to the Second Floor having a Dressing Area and a spacious Ensuite to the side.
- To the Rear is an attractive landscaped Garden, benefitting from TWO ALLOCATED parking spaces.
- EPC Rating B



A BEAUTIFULLY PRESENTED THREE BEDROOM, THREE STOREY SEMI DETACHED FAMILY HOME, pleasantly located within 'Lockside Walk'. Built in 2015 by Taylor Wimpey, the property has a canal side setting and is within close proximity to local amenities. This impressive semi-detached family home provides versatile living accommodation to include a Kitchen, spacious Living Room, downstairs Cloakroom, two Bedrooms and a Family Bathroom to the first floor (the second bedroom is currently used as a Living Room) with the Master Bedroom found to the Second Floor having a Dressing Area and a spacious Ensuite to the side. To the Rear is an attractive landscaped Garden, benefitting from TWO ALLOCATED parking spaces. Offering ready to move in living accommodation, an early view is recommended.



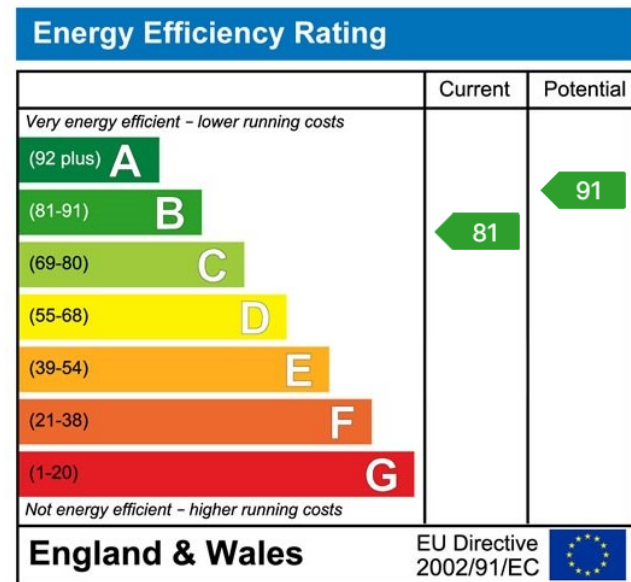
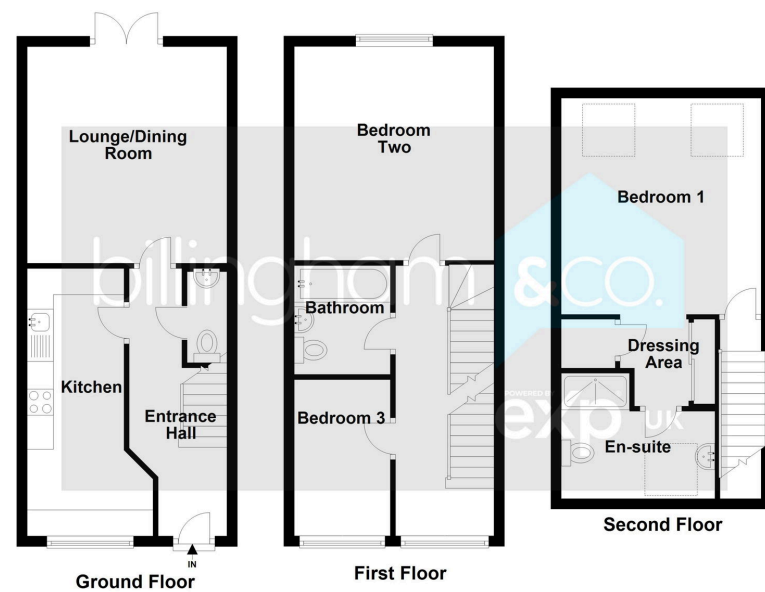

Sales 01384 444 004 / Lettings 01384 445 075
 hello@billingham.properties
 www.billingham.properties



Agents Note: Whilst every care has been taken to prepare these particulars, they are for guidance purposes only. All measurements are approximate and are for general guidance purposes only and whilst every care has been taken to ensure their accuracy, they should not be relied upon and potential buyers are advised to recheck the measurements.